

HERO-LVA SERIES

5KW output power, supporting 4 clusters in parallel, household micro-grid, touching LCD, and supporting screen selection protocols.



▲ This picture is for reference only



LED screen display the parameters of the equipment in real time

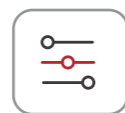

Thin stack design
Modular structure for easy installation



Intelligent battery management system



Support a variety of communication protocols,
support RS485, RS232, CAN etc

| Basic Parameters | 2-module | 3-module |
|--|----------------------------------|----------------------------------|
| Model | HERO-LVA512200 | HERO-LVA512300 |
| Number of battery parallel | 2 | 3 |
| Rated energy | 10.24KWh | 15.36KWh |
| Dimension (W*H*Tmm) | 600*160*1125mm | 600*160*1575mm |
| Rated voltage | 51.2V | 51.2V |
| Rated Capacity | 200Ah | 300Ah |
| Rating charging and discharge multiplied | 0.5C | 0.5C |
| Depth of discharge | 90% | 90% |
| Voltage work | 43.2-58.4V | 43.2-58.4V |
| Output Power | 5KW | 5KW |
| Communication Interface | CAN/485 | CAN/485 |
| Cycles | 6000@25°C /0.5C/80%DOD | 6000@25°C /0.5C/80%DOD |
| Protection level | IP65 | IP65 |
| Cooling method | Natural cooling | Natural cooling |
| Run temperature range | -20-55°C | -20-55°C |
| Storage temperature | -15-40°C | -15-40°C |
| Relative humidity | 0-90%RH | 0-90%RH |
| Certification standards | CB IEC 62619 / CE / UN38.3/ MSDS | CB IEC 62619 / CE / UN38.3/ MSDS |

Scope



Household



Company

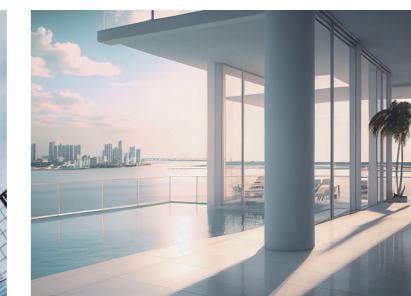

Hotel